



Community Garden

at Community of Christ

990 Meridian Ave., San Jose

Founded 2017

March 2023—Newsletter #36



EXTRA GARDEN ACTIVITIES

I know you'll be busy with your own gardening in March but consider these extra things:

1. Wildflower Watching, March – July, especially in the High Sierras
2. Guadalupe Community Garden, the first garden in San Jose to be irrigated with recycled water.
3. Heritage Rose Garden, 425 Seymour St., San Jose
4. Historic Orchard, south of Taylor near Heritage Rose Garden. Learn about early lifestyle and fruit-picking economy in Santa Clara Valley.
5. Emma Prusch Farm Park, 647 S. King Road, San Jose
 - a. Community Garden, farm animals, fruit trees, picnic area and playground
 - b. Some parts are under renovation right now.
6. Filoli in Woodside
 - a. 56 room mansion in early 1900's, designed for grand scale entertainment
 - b. 16 acres of English Renaissance gardens and orchards
 - c. Marvelous daffodils and tulips in April.
 - d. There is a fee \$22-\$32 (cheaper with membership). Check Filoli.com

What to do in March in the Garden

1. Plant flowers among your kitchen garden plants. They attract Pollinators and beneficial insects. Plant asters, coneflowers, goldenrod, marigolds, yarrow & zinnias to keep pest insects like aphids, hornworms and mealy bugs under control.
2. Transplant warm-deacon crops from end of March through April. Harden off starts before transplanting them, gradually moving them outdoors over 7-10 day window.
3. Time to visit the garden center for starts if you aren't starting from seed.
4. Many plants begin their growth cycle in the spring. They need nutrients, especially nitrogen.
5. Cover your bed with a layer of organic compost or fertilizer to ensure they are well fed.
6. March is a good time to plant potatoes and cold hearty spring crops like radishes, kohlrabi, beets and kale.

Check out these sites online:

Grow Organic.com [weed video](#). "Organic Weed Control" Tips on preventing week germination.

Youtube.com:

- [Easy Garden Activities for Kids](#)
- [Summer Harvest/8 Vegetable Garding Tips for Beginners/Pro Tip Included/Grow Our Own Food](#)

Marcia Plumb

"To plant a garden is to believe in tomorrow." - Audrey Hepburn

TABLE OF CONTENTS

PAGE 1

- **Extra Garden Activities in March**
- **Upcoming Events**

PAGE 2

- **January – March Vegetable/Herb/Fruit Guide**

PAGE 3

- **Milpitas Food Pantry donations**
- **Volunteer opportunities and GG Map**

PAGE 4

- **Grateful Gardens Map Legend**
- **Pictures**

Do you have garden questions, newsletter ideas OR have some free time? Check with Collette or Karen about projects that could use your help. please send an email to gratefulgardenssj@gmail.com

Thanks to WWW.kelloggsgarden.com for much of the information in this month's newsletter.

Perhaps you've noticed our new greenhouse!

Info for Box Renters:

- Every garden box gets one shelf.
- Space is first come, first-serve: tag your own shelf by writing your box number on the tag of the shelf you want. (if a shelf is not tagged, find the tags and a marker on my shelf #22: shed-side, 2nd shelf.)
- If something is on a shelf that is not tagged, and if you want that shelf, move the stuff to an untagged shelf.
- Stacks of various seed trays in that greenhouse are donated by Bill O'Dea. You are free to use them!
- I have a bank of seeds in the office (only because a cooler room=good for seeds) - let me know if you want any.
- That greenhouse is warm. Your seeds will dry out faster than you think. Visit them often or team up with someone to make sure they get the attention they need!

Info for everyone:

- Shelf space is also reserved for people who are working the common areas. Contact myself or Jim Marshall.

Go to the end of the newsletter to see pictures from some of our February happenings!

Upcoming Events

<u>When</u>	<u>Time</u>	<u>What</u>
2 nd Saturday every month	7PM – 9PM	Sound Jose! – Open mic night for electronic music
3 rd Saturday every month	9AM – 12PM	Grateful Gardens Workday
1 st , 2 nd & 4 th Sundays every month	1PM – 3PM	Something to do day – Crafting
3 rd Sunday every month	1PM – 3PM	Blues Sunday
Fridays	Afternoons	ESL with Collette
March 16 th	1:30 PM	Kiss the Ground for <u>Regeneration</u> (Watch the documentary, lunch – Provided by the garden and discussion). https://kisstheground.com/about-us/
March 24 th	Sunrise – Sunset	Palm Sunday Easter Art - Environmental Stations of the Cross by Mary Button
2 nd & 4 th Tuesdays every month starting May 28 th	7PM	Evensong
June 16 th	TBD	Juneteenth Celebration
September 2 nd	TBD	Grand Prix

March – May Vegetable/Herb/Fruit Guide

Sow Seeds	Plant	Harvest	LEGEND				NOTES	
Plant	Seeds	Plants	MAR	APR	MAY			
Artichoke		Transplant						
Artichoke		Transplant						
Artichoke		Transplant						
Arugula	Direct Sow							
Arugula	Direct Sow							
Asparagus		Transplant					Dig trench 12-18" wide and 6-8 " deep. Loosen soil deeper for best results.	
Asparagus		Transplant					Dig trench 12-18" wide and 6-8 " deep. Loosen soil deeper for best results.	
Beans	Direct Sow						Direct sow.	
Beans	Direct Sow						Direct sow.	
Beets	Direct Sow						Thin to 3" apart, final spacing 5"	
Beets	Direct Sow						Thin to 3" apart, final spacing 5"	
Bell Peppers		Transplant					Ideal Temp 80-90 degrees	
Bell Peppers		Transplant					Ideal Temp 80-90 degrees	
Broccoli	Direct Sow	Transplant					Select a variety best suited to your climate that will mature before hot weather begins.	
Broccoli	Direct Sow	Transplant					Select a variety best suited to your climate that will mature before hot weather begins.	
Broccoli	Direct Sow	Transplant						Select a variety best suited to your climate that will mature before hot weather begins.
Brussel Sprouts		Transplant					Long growing season. Flavor improves with light frost.	
Brussel Sprouts		Transplant					Long growing season. Flavor improves with light frost.	
Brussel Sprouts		Transplant						Long growing season. Flavor improves with light frost.
Cabbage	Direct Sow	Transplant					Cooler season crop	
Cabbage	Direct Sow	Transplant					Cooler season crop	
Cabbage	Direct Sow	Transplant					Cooler season crop	
Carrots	Direct Sow						Dislikes transplanting	
Carrots	Direct Sow						Dislikes transplanting	
Cauliflower	Direct Sow	Transplant					Brassica family.	
Cauliflower	Direct Sow	Transplant					Brassica family.	

Cauliflower	Direct Sow	Transplant							Brassica family.
Celery		Transplant							Thin to 10-12 inches when seedlings have 3-4 true leaves.
Celery		Transplant							Thin to 10-12 inches when seedlings have 3-4 true leaves.
Celery		Transplant							Thin to 10-12 inches when seedlings have 3-4 true leaves.
Collards	Direct Sow								Brassica family.
Corn	Direct Sow								Needs to be planting in rows for pollination.
Cucumbers	Direct Sow	Transplant							Consider growing vertically on support structures.
Cucumbers	Direct Sow	Transplant							Consider growing vertically on support structures.
Edamame	Direct Sow								Long growing season. Succession plant for continual harvest.
Eggplant		Transplant							Transplant to garden or container.
Eggplant		Transplant							Transplant to garden or container.
Endive	Direct Sow								Direct Sow and thin to 6-12 inches apart
Endive	Direct Sow								Direct Sow and thin to 6-12 inches apart
Fava Beans	Direct Sow								Prefers cooler weather.
Garlic	Direct Sow	Transplant							Planting in Fall yields larger bulbs.
Gourds	Direct Sow	Transplant							Plant in hills that are well-spaced.
Gourds	Direct Sow	Transplant							Plant in hills that are well-spaced.
Green Beans	Direct Sow								Grow on support structure such as teepees.
Horseradish		Transplant							Plant root cuttings18 inches apart in trenches 3 to 4 inches deep.
Horseradish		Transplant							Plant root cuttings18 inches apart in trenches 3 to 4 inches deep.
Horseradish		Transplant							Plant root cuttings18 inches apart in trenches 3 to 4 inches deep.
Kale	Direct Sow	Transplant							Brassica family
									Brassica family
									Brassica family
Leeks		Transplant						Onion family	
Leeks		Transplant						Onion family	
Leeks		Transplant						Onion family	
Lettuce	Direct Sow	Transplant							Plant in succession
Lettuce	Direct Sow	Transplant							Plant in succession
Lettuce	Direct Sow	Transplant							Plant in succession
Okra		Transplant							Soak seeds overnight before planting.
Okra		Transplant							Soak seeds overnight before planting.
Onions		Transplant							
Onions		Transplant							
Onions		Transplant							
Parsnips	Direct Sow								Direct sow 1" apart in wide rows. Thin to 3-4".
Potatoes		Transplant							Give potato seeds a head start by pre-sprouting or chitting them before planting.
Potatoes		Transplant							Give potato seeds a head start by pre-sprouting or chitting them before planting.
Pumpkins	Direct Sow	Transplant							
Radishes	Direct Sow								Plant in succession.
Radishes	Direct Sow								Plant in succession.
Rhubarb		Transplant							Possible to plant from seed, but less successful. Planting rhizomes recommended. Heavy feeders.
Rhubarb		Transplant							Possible to plant from seed, but less successful. Planting rhizomes recommended. Heavy feeders.
Rutabagas	Direct Sow								Direct sow 1-2" apart in wide rows. Thin to 8 inches
Shallots	Direct Sow	Transplant							Onion family

Shallots	Direct Sow	Transplant								Onion family
Shallots	Direct Sow	Transplant								Onion family
Snap Peas	Direct Sow									Plant in succession. Use support structure.
Soybean	Direct Sow									
Spinach	Direct Sow	Transplant								Plant in succession for continual harvest.
Squash	Direct Sow	Transplant								Consider growing on support structure.
Squash	Direct Sow	Transplant								Consider growing on support structure.
Sweet Potatoes		Transplant								Grown from slips, not seeds. 50 Sprouts per slip. Wider spacing produces larger sweet potatoes.
Swiss Chard	Direct Sow	Transplant								Plant in succession.
Swiss Chard	Direct Sow	Transplant								Plant in succession.
Swiss Chard	Direct Sow	Transplant								Plant in succession.
Tomatoes		Transplant								May require staking. Transfer to to bed or planter.
Tomatoes		Transplant								May require staking. Transfer to to bed or planter.
Tomatoes		Transplant								May require staking. Transfer to to bed or planter.
Turnips	Direct Sow									
Turnips	Direct Sow									
Zucchini	Direct Sow	Transplant								Plant 3-4 seeds per mound 4 inches high.
Zucchini	Direct Sow	Transplant								Plant 3-4 seeds per mound 4 inches high.
Zucchini	Direct Sow	Transplant								Plant 3-4 seeds per mound 4 inches high.
Basil	Direct Sow	Transplant								Grown for its leaves which are used as a herb
Basil	Direct Sow	Transplant								Grown for its leaves which are used as a herb
Basil	Direct Sow	Transplant								Grown for its leaves which are used as a herb
Catnip	Direct Sow									Strong scent. Pink or white flowers
Catnip	Direct Sow									Strong scent. Pink or white flowers
Chives	Direct Sow	Transplant								Onion family. Long hollow leaves. Cut six to eight inches from the top of the plants. This allows vigorous growth throughout the season.
Chives	Direct Sow	Transplant								Onion family. Long hollow leaves. Cut six to eight inches from the top of the plants. This allows vigorous growth throughout the season.
Chives	Direct Sow	Transplant								Onion family. Long hollow leaves. Cut six to eight inches from the top of the plants. This allows vigorous growth throughout the season.
Cilantro (Slow Bolt)	Direct Sow									Soft leafy herb with small whitish-pink flowers in clusters
Cilantro (Slow Bolt)	Direct Sow									Soft leafy herb with small whitish-pink flowers in clusters
Coriander	Direct Sow									Parsley family. Small green leaves.
Coriander	Direct Sow									Parsley family. Small green leaves.
Dill	Direct Sow									Aromatic blueish green plant with feathery leaves.
Dill	Direct Sow									Aromatic blueish green plant with feathery leaves.
Fennel	Direct Sow									Hollow stems and feathery foliage.
Fennel	Direct Sow									Hollow stems and feathery foliage.
Goldenrod	Direct Sow	Transplant								Plumes of fluffy yellow flowers. Attracts beneficial insects.
Goldenrod	Direct Sow	Transplant								Plumes of fluffy yellow flowers. Attracts beneficial insects.
Goldenrod	Direct Sow	Transplant								Plumes of fluffy yellow flowers. Attracts beneficial insects.

Lavender	Direct Sow	Transplant						Purple flowers. Direct sow spring or summer. Wound and digestive remedies. The herb can be harvested in the summer when just coming into flower (now) and can be dried for later use. The roots can be dug and boiled for a salad as they are starchy with a nutty taste.
Lavender	Direct Sow	Transplant						Purple flowers. Direct sow spring or summer. Wound and digestive remedies. The herb can be harvested in the summer when just coming into flower (now) and can be dried for later use. The roots can be dug and boiled for a salad as they are starchy with a nutty taste.
Lavender (French - Purple Ribbon)	Direct Sow	Transplant						Bush - Blue flowers. Mint family, Medicinal anti-viral, attracts pollinators
Lavender (French - Purple Ribbon)	Direct Sow	Transplant						Bush - Blue flowers. Mint family, Medicinal anti-viral, attracts pollinators
Lavender Lavandula vera	Direct Sow	Transplant						Purple/ blue Flowers. Mint family, Medicinal anti-viral, attracts pollinators
Lavender Lavandula vera	Direct Sow	Transplant						Purple/ blue Flowers. Mint family, Medicinal anti-viral, attracts pollinators
Lemon Balm	Direct Sow	Transplant						Lovely lemon scented leaves
Lemon Balm	Direct Sow	Transplant						Lovely lemon scented leaves
Marjoram		Transplant						Oval or round leaves on woody stems. Used in cooking and medicinally. Start seeds indoors.
Marjoram		Transplant						Oval or round leaves on woody stems. Used in cooking and medicinally. Start seeds indoors.
Marjoram		Transplant						Oval or round leaves on woody stems. Used in cooking and medicinally. Start seeds indoors.
Mint		Transplant						Aromatic green leaves. Quick to self-propagate
Mint		Transplant						Aromatic green leaves. Quick to self-propagate
Mint		Transplant						Aromatic green leaves. Quick to self-propagate
Mustard	Direct Sow							Produces billows of tiny, four-petaled yellow flowers. Brassica family. Consider staking plants.
Mustard	Direct Sow							Produces billows of tiny, four-petaled yellow flowers. Brassica family. Consider staking plants.
Oregano		Transplant						Aromatic, dark green leaves/white, pink, purple flowers. Mint Family
Oregano		Transplant						Aromatic, dark green leaves/white, pink, purple flowers. Mint Family
Oregano		Transplant						Aromatic, dark green leaves/white, pink, purple flowers. Mint Family
Parsley	Direct Sow	Transplant						Aromatic dark green leaves/yellow flowers. Carrot family
Parsley	Direct Sow	Transplant						Aromatic dark green leaves/yellow flowers. Carrot family
Parsley	Direct Sow	Transplant						Aromatic dark green leaves/yellow flowers. Carrot family
Roselle (Red) Hibiscus sabdariffa		Transplant						Tall, tropical, red and green shrub/cranberry taste. Produces when days get shorter
Roselle (Red) Hibiscus sabdariffa		Transplant						Tall, tropical, red and green shrub/cranberry taste. Produces when days get shorter
Roselle (Red) Hibiscus sabdariffa		Transplant						Tall, tropical, red and green shrub/cranberry taste. Produces when days get shorter
Rosemary		Transplant						Fragrant, small pine needle-like leaves. Mint Family. Slow to germinate with 30% success rate.

Rosemary		Transplant							Fragrant, small pine needle-like leaves. Mint Family. Slow to germinate with 30% success rate.
Rosemary		Transplant							Fragrant, small pine needle-like leaves. Mint Family. Slow to germinate with 30% success rate.
Sage	Direct Sow	Transplant							Aromatic shrub with silvery leaves and purple flowers. Thin and transplant when 2 true sets of leaves are present.
Sage	Direct Sow	Transplant							Aromatic shrub with silvery leaves and purple flowers. Thin and transplant when 2 true sets of leaves are present.
Sage	Direct Sow	Transplant							Aromatic shrub with silvery leaves and purple flowers. Thin and transplant when 2 true sets of leaves are present.
Stevia	Direct Sow	Transplant							Aromatic herb used as a natural sweetener
Stevia	Direct Sow	Transplant							Aromatic herb used as a natural sweetener
Stevia	Direct Sow	Transplant							Aromatic herb used as a natural sweetener
Tarragon	Direct Sow	Transplant							Tender and leafy, aromatic herb. Start seeds indoors. Low light. Room temperature.
Tarragon	Direct Sow	Transplant							Tender and leafy, aromatic herb. Start seeds indoors. Low light. Room temperature.
Tarragon	Direct Sow	Transplant							Tender and leafy, aromatic herb. Start seeds indoors. Low light. Room temperature.
Thyme		Transplant							Small aromatic shrub with woody stems. Mint family. Thinly scatter seeds and sprinkle with soil.
Thyme		Transplant							Small aromatic shrub with woody stems. Mint family. Thinly scatter seeds and sprinkle with soil.
Thyme		Transplant							Small aromatic shrub with woody stems. Mint family. Thinly scatter seeds and sprinkle with soil.
Blackberries		Transplant							Stratify seeds. Once seedlings are 4 inches in height, they can be planted outdoors.
Blueberries		Transplant							Start seeds in trays for later transplant.
Cantaloupes	Direct Sow	Transplant							Direct sow 2-3 seeds per hill.
Cantaloupes	Direct Sow	Transplant							Direct sow 2-3 seeds per hill.
Currants		Transplant							Stratify seeds. When seedlings germinate, transplant them from seed flat into pots.
Currants		Transplant							Stratify seeds. When seedlings germinate, transplant them from seed flat into pots.
Grapes		Transplant							Plant seedling vines 6-10 feet apart.
Honeydew	Direct Sow	Transplant							Direct sow 2-3 seeds per hill.
Honeydew	Direct Sow	Transplant							Direct sow 2-3 seeds per hill.
Honeydew	Direct Sow	Transplant							Direct sow 2-3 seeds per hill.
Raspberries		Transplant							
Strawberries		Transplant							Plant in mounded rows.
Watermelon	Direct Sow	Transplant							Direct sow 2-3 seeds per hill.
Watermelon	Direct Sow	Transplant							Direct sow 2-3 seeds per hill.

VOLUNTEER OPPORTUNITIES

*The garden has many volunteer opportunities. **Following is a map and legend of the stations** within the garden.*

The volunteer would adopt the station and maintain the area.

We'll be sharing more detailed information about this on the website.

Check out our new GREENHOUSE!

It has weathered the recent storms. Thanks Jim and Ryan, and others who have helped.



Milpitas Food Pantry

EXTRA VEGGIES? If you have extra veggies, consider donating to a food pantry!

Marcia works at Milpitas Food Pantry and can pick up extra produce Monday and Wednesday evenings.

If you are interested, she can be reached at the following number 408.892.8924.



Milpitas Food Pantry

Emergency Food & Food Assistance
For Residents of Milpitas and Alviso

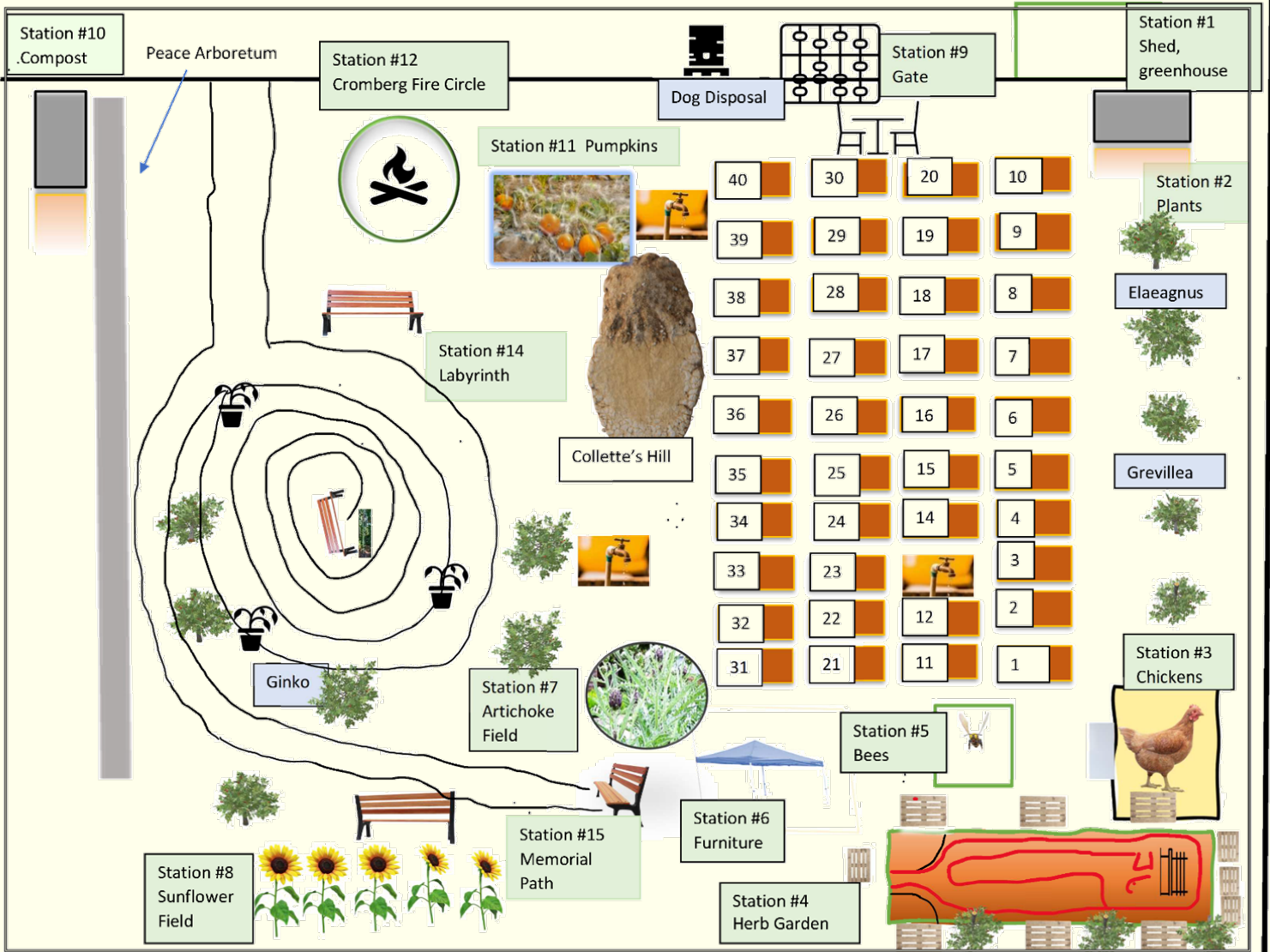

Grateful Gardens Map Legend

- Station 1:** Shed and surrounding area – **Time:** 1-2 hours per week
- Station 2:** Elaeagnus, Grevillea bushes – **Time:** 1-2 hours per week
- Station 3:** Chickens – **Time:** 5-6 hours per week
- Station 4:** Herb Garden – **Time:** 2-3 hours per week
- Station 5:** Bees – Bees need specialized care by knowledgeable staff
- Station 6:** Furniture, Pop up – **Time:** varies based on project
- Station 7:** Artichoke Field – **Time:** 2-3 hours per week
- Station 8:** Sunflower field – **Time:** 2-3 hours per week
- Station 9:** Gate – **Time:** 2-3 hours per week
- Station 10:** Compost – **Time:** 4-6 hours per week
- Station 11:** Pumpkin field – **Time:** 2-3 hours per week
- Station 12:** Cromberg Fire Circle – **Time:** 2-3 hours per week
- Station 14:** Labyrinth – **Time:** 3-5 hours per week
- Station 15:** Memorial Path – **Time:** 1-2 hours per week

Sequoia Drama Club – Came to visit in preparation for their spring production, **COMMUNITY GARDEN**



Blues Jam Session!



Seed Swap and Dinner

