



Community Garden

at Community of Christ

990 Meridian Ave., San Jose

Founded 2017

February 2024—Newsletter #35



"To plant a garden is to believe in tomorrow." - Audrey Hepburn

A Message from the Gardens Executive Director

In 2024, the spotlight is on the powerful Dragon, promising a year filled with opportunities and challenges. I am feeling that way about our beautiful garden. We have been working on this little plot of land for seven years. (That sounds poetic.) We have installed infrastructure, battled the weeds, created art, explored spiritual paths, created a community, and oh yes, we have grown vegetables and flowers. I am constantly delighted when I come to the garden and see new little installations of plants and hardscapes in lovely configurations that soothe the soul. Thank you to everyone who is part of creating this garden. The garden looks great!

2024 will be a powerful year for new infrastructure and programs. First, our box holders will be happy to hear that we will be installing a greenhouse in February. The greenhouse is 8 x 14. It will be placed behind the shed. We are hoping to create a gutter system on the greenhouse to capture rainwater for the garden.

You may have noticed on the south side of the garden a series of arches. This is the beginning of our Peace Arboretum. There are four rooms in this installation, Peace for me, Peace for us, Peace for everyone, and Peace for the planet. We will explore this complex and difficult subject in our lives. Our goal is to design a series of exhibits and activities that will help people think about and practice peace for themselves and in the world.

One of the projects is an art installation using peace poles. We are inviting individuals, families, and groups to design and paint peace poles which exemplify each of the ideas in the rooms. We would like 6-10 poles in each room. We will have a peace pole planting in the spring. The garden will purchase the poles and paint supplies. An instruction package and more details will be available soon. If you would like to participate in this project or have ideas, please contact Collette. We will have a dedication service for the arboretum in late May.

I came across a wonderful organization dedicated to the pursuit of peace. It is the Mahatma Gandhi Canadian Foundation for World Peace. One of their programs is called **"The Season for Nonviolence"**. This is 64 days of daily meditations, quotes, videos, etc. It starts on January 30, 2024, and ends on April 4, 2024.

TABLE OF CONTENTS

PAGE 1

- **Message from the Gardens Executive Director**

PAGE 2

- **Events**
- **What we can learn from bees**

PAGE 3

- **Thank you to Kellogg Garden & OMRI**
- **January – March Vegetable/Herb/Fruit Guide**

PAGE 4

- **Milpitas Food Pantry donations**
- **Volunteer opportunities and GG Map**

PAGE 5

- **Grateful Gardens Map Legend**
- **Pictures**

Cont. Message from the Gardens Executive Director

These dates are the anniversaries of the assassination of Mahatma Gandhi and Martin Luther King Jr. The meditations take about ten minutes, and they are powerful lessons. I invite you to look at the website and gather your family and friends to participate. Maybe we can change the world or at least our little corner.

<https://www.gandhifoundation.ca/season-for-nonviolence.html>

And as if that was not enough, I have one more item. We have come across a great film called **"Kiss the Ground"**. In this film the idea of reversing the effects of carbon in the atmosphere is discussed and the principle of carbon drawdown is introduced. We will be showing this film in the church building on March 16th. **The popcorn is on us!** I hope you will plan to attend. The film is something to get excited about, a way to make a difference.

Though out the year there will be programs, events, celebrations, and community and oh yes, growing vegetables and flowers. Thank you for all you do in our little garden with big ideas. I hope 2024 is a powerful year for you.

Karen Marshall
Executive Director

Upcoming Events

<u>When</u>	<u>Time</u>	<u>What</u>
2 nd Saturday every month	7PM – 9PM	Sound Jose! – Open mic night for electronic music
3 rd Saturday every month	9AM – 12PM	Grateful Gardens Workday
1 st , 2 nd & 4 th Sundays every month	1PM – 3PM	Something to do day – Crafting
3 rd Sunday every month	1PM – 3PM	Blues Sunday
Fridays	Afternoons	ESL with Collette
February 17 th	9AM – 12PM	Grateful Garden Orientation meeting
March 16 th	11AM -	Kiss the Ground for <u>Regeneration</u> (Watch the documentary, lunch – Provided by the garden and discussion). https://kisstheground.com/about-us/
March 24 th	Sunrise – Sunset	Palm Sunday Easter Art - Environmental Stations of the Cross by Mary Button
2 nd & 4 th Tuesdays every month starting May 28 th	7PM	Evensong
June 16 th	TBD	Juneteenth Celebration
September 2 nd	TBD	Grand Prix

Three little Bees or Bee kind always

My dad has bees.

Today I went to his house, and he showed me all of the honey he had gotten from the hives. He took the lid off of a 5-gallon bucket full of honey and on top of the honey there were three little bees, struggling.

They were covered in sticky honey and drowning. I asked him if we could help them, and he said he was sure they wouldn't survive. Casualties of honey collection I suppose.

I asked him again if we could at least get them out and kill them quickly, after all he was the one who taught me to put a suffering animal (or bug) out of its misery.

He finally conceded and scooped the bees out of the bucket. He put them in an empty Chobani yogurt container and put the plastic container outside.

Because he had disrupted the hive with the earlier honey collection, there were bees flying all over outside.

We put the three little bees in the container on a bench and left them to their fate. My dad called me out a little while later to show me what was happening. These three little bees were surrounded by all of their sisters (all of the bees are females) and they were cleaning the sticky nearly dead bees, helping them to get all of the honey off of their bodies. We came back a short time later and there was only one little bee left in the container. She was still being tended to by her sisters.

When it was time for me to leave, we checked one last time and all three of the bees had been cleaned off enough to fly away and the container was empty.

Those three little bees lived because they were surrounded by family and friends who would not give up on them, family and friends who refused to let them drown in their own stickiness and resolved to help until the last little bee could be set free.

Bee Sisters. Bee Peers. Bee Teammates.

We could all learn a thing or two from these bees.

Bee kind always



~author unknown~

art: Autumn Skye Morrison

Thanks to www.kelloggsgarden.com for much of the information in this month's newsletter.

We are an organic community garden.
Please use only OMRI approved products including soil amendments, fertilizers, and pest control products.



January – March Vegetable/Herb/Fruit Guide

	Sow Seeds	Plant	Harvest					
Plant	Seeds	Plants	JAN	FEB	MAR	Seed Depth	Plant Spacing	NOTES
Artichoke		Transplant				1/2"	3'	
Arugula	Direct Sow					1/4"	1"	
Asparagus		Transplant						Dig trench 12-18" wide and 6-8" deep. Loosen soil deeper for best results.
Beets	Direct Sow					1/2"	5"	Thin to 3" apart, final spacing 5"
Brussel Sprouts		Transplant				1/2"	18"	Long growing season. Flavor improves with light frost.
Celery		Transplant				1/4"	12"	Thin to 10-12 inches when seedlings have 3-4 true leaves.
Eggplant		Transplant				1/4-1/2"	18"	Transplant to garden or container.
Horseradish		Transplant				3-4"	18"	Plant root cuttings 18 inches apart in trenches 3 to 4 inches deep.
Leeks		Transplant				1/4"	4-6"	Onion family
Lettuce	Direct Sow	Transplant				1/8-1/4"	8-10"	Plant in succession
Shallots	Direct Sow	Transplant				2-3"	6"	Onion family
Tomatoes		Transplant				1/8-1/4"	24"	May require staking. Transfer to to bed or planter.
Basil	Direct Sow	Transplant				1/4"	1"	Grown for its leaves which are used as a herb
Chives	Direct Sow	Transplant				1/8"	Scatter thinly	Onion family. Long hollow leaves. Cut six to eight inches from the top of the plants. This allows vigorous growth throughout the season.
Goldenrod	Direct Sow	Transplant				1/8"	Thinly scatter	Plumes of fluffy yellow flowers. Attracts beneficial insects.
Lavender	Direct Sow	Transplant				1/8"	5 seeds per 10"	Purple flowers. Direct sow spring or summer. Wound and digestive remedies. The herb can be harvested in the summer when just coming into flower (now) and can be dried for later use. The roots can be dug and boiled for a salad as they are starchy with a nutty taste.
Lavender (French - Purple Ribbon)	Direct Sow	Transplant				1/8"	5 seeds per 10"	Bush - Blue flowers. Mint family, Medicinal anti-viral, attracts pollinators
Lavender Lavandula vera	Direct Sow	Transplant				1/8"	18"	Purple/ blue Flowers. Mint family, Medicinal anti-viral, attracts pollinators
Marjoram		Transplant				3x seed diameter	2"	Oval or round leaves on woody stems. Used in cooking and medicinally. Start seeds indoors.
Mint		Transplant				1/8"	18"	Aromatic green leaves. Quick to self propagate
Mustard	Direct Sow					1/2-1"	2"	Produces billows of tiny, four-petaled yellow flowers. Brassica family. Consider staking plants.
Oregano		Transplant				1/8"	Scatter thinly	Aromatic, dark green leaves/white, pink, purple flowers. Mint Family
Parsley	Direct Sow	Transplant				1/4"	1"	Aromatic dark green leaves/yellow flowers. Carrot family
Roselle (Red) Hibiscus sabdariffa		Transplant				1/4-1/2"	Scatter thinly	Tall, tropical, red and green shrub/ cranberry taste. Produces when days get shorter

Rosemary		Transplant				1/4-1/8"	1 per pot	Fragrant, small pine needle-like leaves. Mint Family. Slow to germinate with 30% success rate.
Sage	Direct Sow	Transplant						Aromatic shrub with silvery leaves and purple flowers. Thin and transplant when 2 true sets of leaves are present.
Tarragon	Direct Sow	Transplant				1/2"	6 seeds per pot	Tender and leafy, aromatic herb. Start seeds indoors. Low light. Room temperature.
Thyme		Transplant				1/4"	Thinly scatter	Small aromatic shrub with woody stems. Mint family. Thinly scatter seeds and sprinkle with soil.
Thyme		Transplant				1/4"	Thinly scatter	Small aromatic shrub with woody stems. Mint family. Thinly scatter seeds and sprinkle with soil.
Thyme		Transplant						Small aromatic shrub with woody stems. Mint family. Thinly scatter seeds and sprinkle with soil.
Figs		Transplant						Propagate indoors in pots until established.

Milpitas Food Pantry

EXTRA VEGGIES? If you have extra veggies, consider donating to a food pantry!

Marcia works at Milpitas Food Pantry and can pick up extra produce Monday and Wednesday evenings. If you are interested, she can be reached at the following number 408.892.8924.



VOLUNTEER OPPORTUNITIES

The garden has many volunteer opportunities. **Following is a map and legend of the stations within the garden.**

The volunteer would adopt the station and maintain the area.

We'll be sharing more detailed information about this on the website.

Grateful Gardens Map Legend

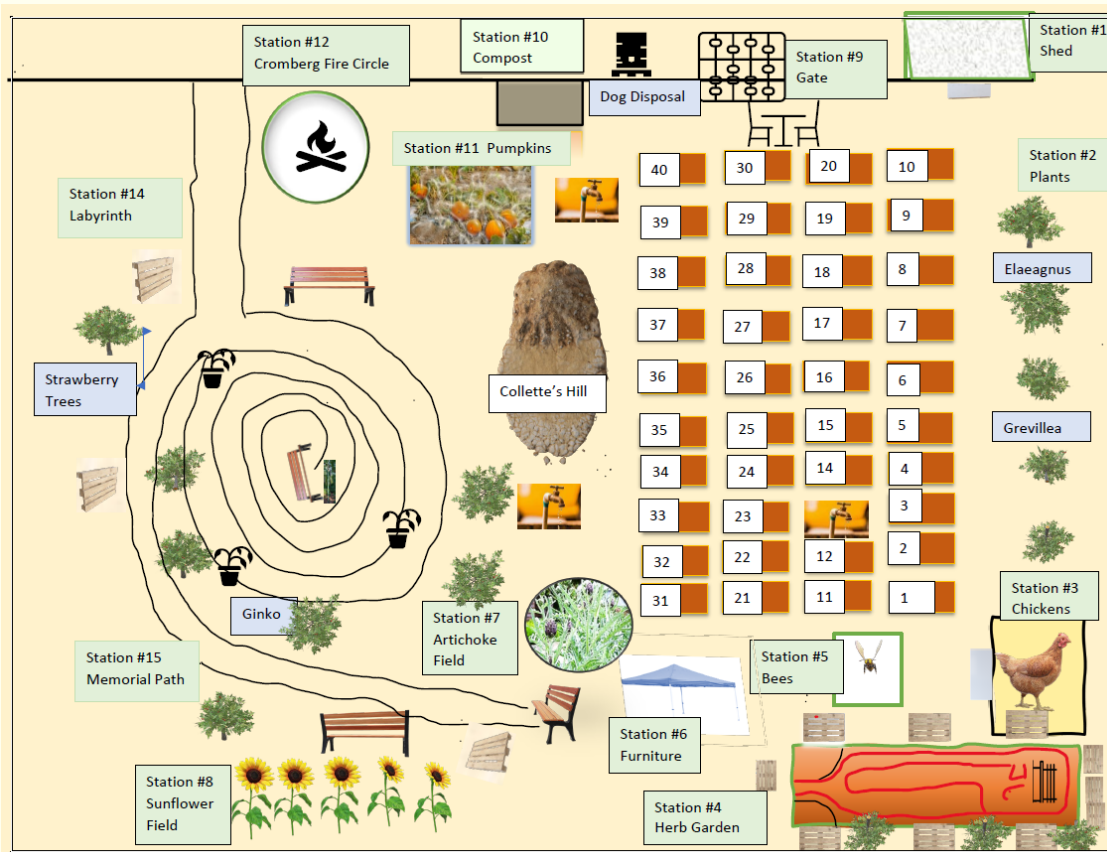

- Station 1:** Shed and surrounding area – **Time:** 1-2 hours per week
- Station 2:** Elaeagnus, Grevillea bushes – **Time:** 1-2 hours per week
- Station 3:** Chickens – **Time:** 5-6 hours per week
- Station 4:** Herb Garden – **Time:** 2-3 hours per week
- Station 5:** Bees – Bees need specialized care by knowledgeable staff
- Station 6:** Furniture, Pop up – **Time:** varies based on project
- Station 7:** Artichoke Field – **Time:** 2-3 hours per week
- Station 8:** Sunflower field – **Time:** 2-3 hours per week
- Station 9:** Gate – **Time:** 2-3 hours per week
- Station 10:** Compost – **Time:** 4-6 hours per week
- Station 11:** Pumpkin field – **Time:** 2-3 hours per week
- Station 12:** Cromberg Fire Circle – **Time:** 2-3 hours per week
- Station 14:** Labyrinth – **Time:** 3-5 hours per week
- Station 15:** Memorial Path – **Time:** 1-2 hours per week

Grateful Gardens
 Peace Arboretum
 Coming Soon!

